

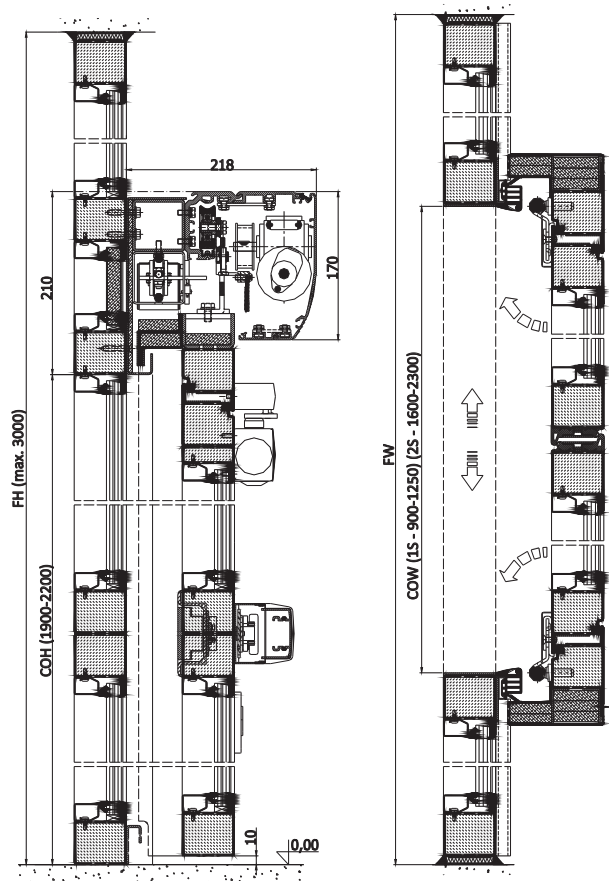

FIRE ESCAPE AUTOMATIC SLIDING DOORS

300⁺ EF

Fire escape automatic sliding doors with a fire resistance EI30 are intended to be installed at the borders of fire sectors, as well as on the escape route crossings. The doors combine the day – to – day comforts of a sliding door with a safe solution in case of fire and are primarily used to prevent spread of fire. Fire escape automatic sliding doors must ensure a safe evacuation of people and goods, and at the same time prevent the spread of fire. In normal circumstances these doors function as standard automatic sliding doors enabling easy passage. However, upon activation of a fire signal, power failure or upon malfunctioning of the doors, they will close automatically and completely mechanically. The doors automatically switch to swing operating mode and allow for easy swing opening of the leafs and a safe evacuation. They can be opened with a pull handle or panic push bar and will close automatically, due to an integrated self-closing mechanism. Therefore, fire protection is fully guaranteed.



Technical data

1 - leaf sliding doors	Clear opening width: 90 – 125 cm Clear opening height: 190 – 220 cm
2 - leaf sliding doors	Clear opening width: 160 – 230 cm Clear opening height: 190 – 220 cm
Fire resistance	EI30 or EW30 (C) with mechanical sliding and swing self-closing ability
Application	300 F for NON ESCAPE routes 300 EF for ESCAPE routes, variety of: panic push bar, pull handle outside, pull handle inside
Opening - closing speed	3 - 70 cm/s (adjustable)
Opening time	0 - 15 s (adjustable)
Power consumption	30 / 150VA
Functionality	Variety of adjustable functions and parameters Digital programme switch COM20 Connection to fire safety system Electro-thermal safety fire protection Warning diagnostics with COM20 program switch Alarm and error diagnostics with COM20 program switch Digital regulation of the operator
Program switch	7 operating regimes: auto-summer, auto-winter, one way-summer, one way-winter, closed, open, stop
Security	Infrared-microwave activation sensors Safety sensors with monitoring function
Glazing	EI30: 16 - 17 mm EW30: 11 mm Panel solution: 17 mm
Color	Ral color
Standards	EN16034, EN16361, EN16005, DIN18650, EN179, EN1125, EN1154, Certified production REG2-0004-03-ZGPro1-2644, STS-10/0023, Klassifizierungsbericht Nr. 315052004-A

