

DORMA Studio-Rondo

DORMA Studio-Rondo has a charm and neatness in its simple, uncluttered lines that serves to enhance the inherent beauty and character of toughened glass doors.

The extensive range of colours offers scope for the imagination.

Door dimensions

- Glass thickness:
8 mm
- Door weight:
max. 45 kg
- Door width:
max. 1000 mm
- Standard frame depth:
24 mm

Materials and finishes

Aluminium, anodised

- Silver, LM EV1, CO (101)
- New silver, LM EV2 (102)
- Similar to stainless steel, satin (107)
- Dark bronze, LM DB14, MC1003, C34 (108)
- Gold-bronze (110)
- Brass, LM EV3 (105)
- Special anodised finish, SE (199)

Aluminium, coated

- White, RAL 9016 (300)
- Grey (303)
- Black (304)
- Brown (305)
- Red (306)
- Wine-red (307)
- Dark blue (313)
- Special colour finishes, SF (399)

Brass

- Polished, coated (502)
- Polished chrome (501)



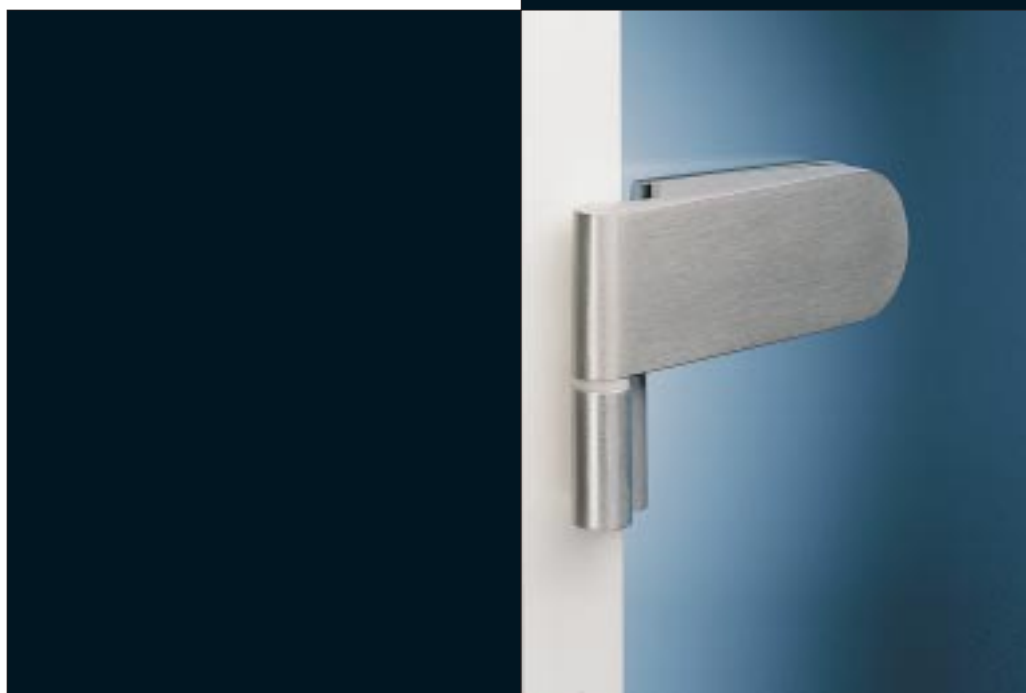

 STUDRON

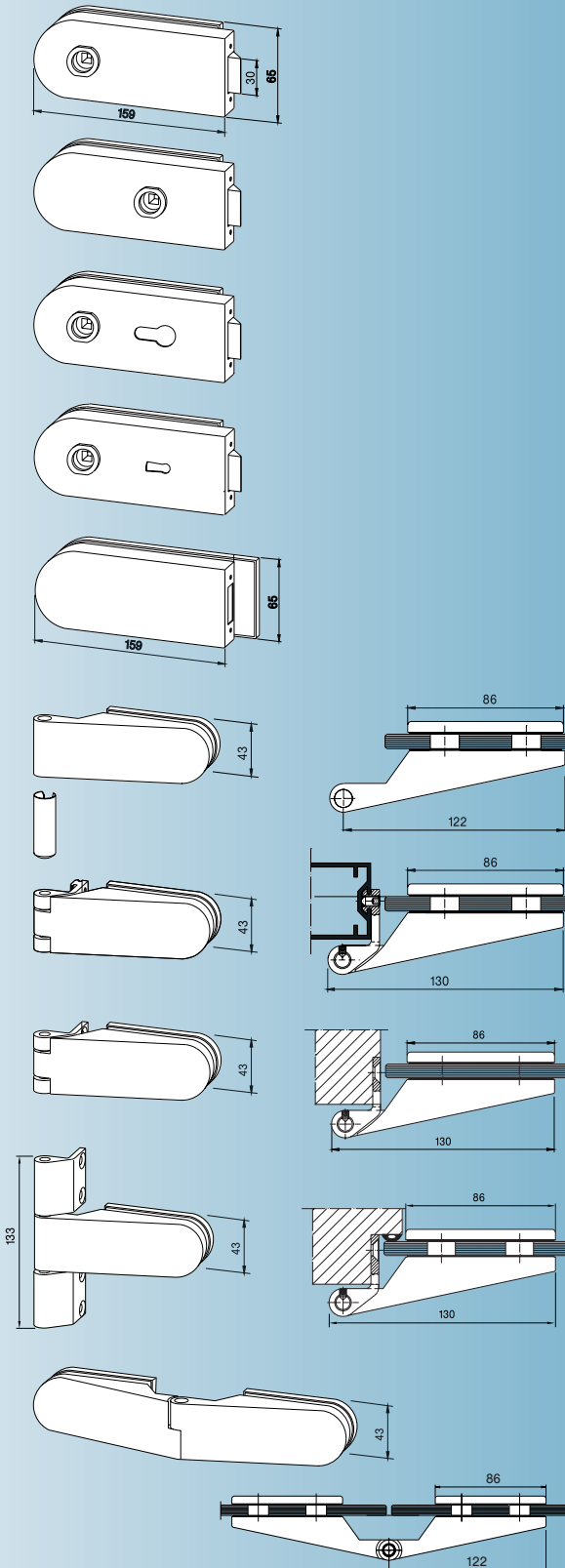

DORMA Studio-Rondo



Locks and latches	With lever guide	For levers with roses
Non-locking	 10.200	 10.210
For lever front, non-locking	10.201	10.211
Prepared for Europrofile cylinder, with night latch function	10.202	10.112
Warded lever lock with night latch function, 2 keys	10.203	10.113
Strike box for double doors	10.220	10.220
Hinges	Glass thickness 8 mm/10 mm	
For frame pivots with sleeve	10.230/10.236	
With frame pivot for aluminium frame	10.231/10.237 max. 35 kg door weight	
With blade for timber frame	10.232/10.238 max. 35 kg door weight	
Strengthened, with blade for timber frame and 2 hinge flaps	10.235/10.239	
For fixing to glass side panels	10.244*/10.245* 10.246**/10.247**	
*LH, **RH		
Levers and frame pivots, Page 3.10		

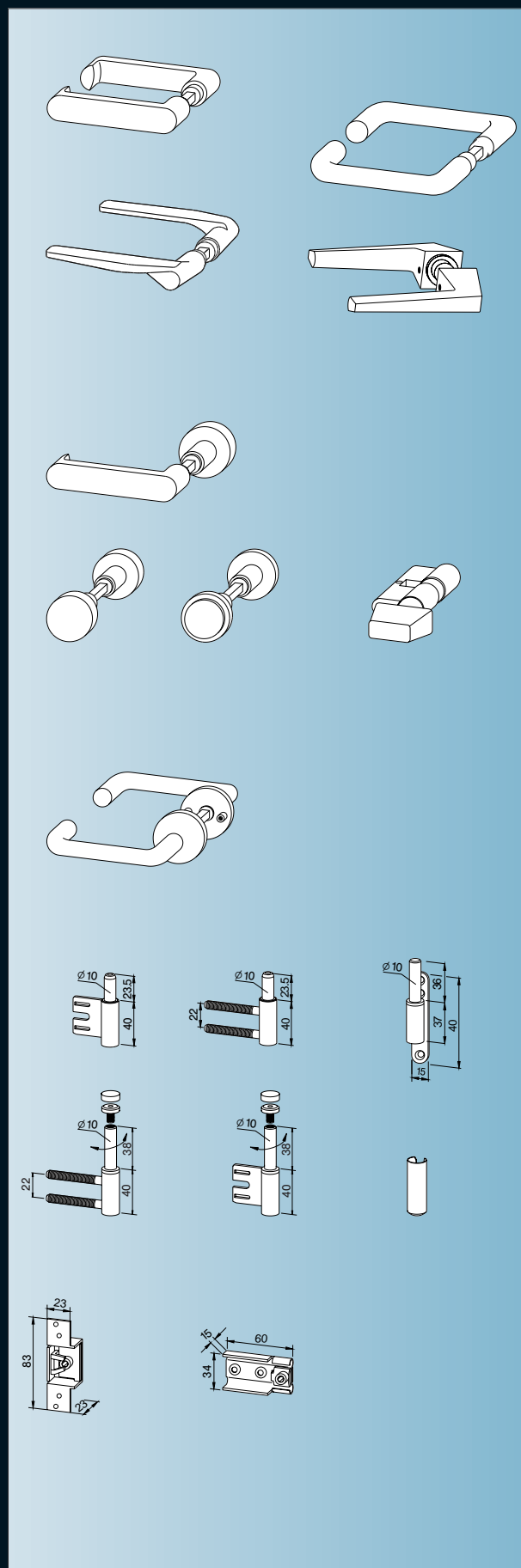

Door lever sets for locks with lever guide

- With flat hand part 10.314
- Tubular design, aluminium 10.301
- Polyamide (nylon) coated steel 10.303
- With cantilevered hand part 10.300
- With angular hand part 10.010

Lever and knob set, lever with flat hand part, fixed knob, for use with night latch function locks 10.304

Set of knobs, turn knob, flat 10.305

Set of knobs, turn knob with beading 10.306

Thumbturn cylinder 10.310

Door lever sets with roses

- Tubular design, aluminium 10.307
- Polyamide (nylon) coated steel 10.312

Frame pivots

for steel frames, plastic coated pivot pin 10.400

for timber frame, plastic coated pivot pin 10.404

Screw-on frame pivot, plastic coated pivot pin 10.407

Riser with threaded spindle for timber frame 10.416/10.417*

Riser with threaded spindle for steel frame 10.418/10.419*

Push-on sleeve for 10.400, 10.404, 10.407 10.408

Frame pocket for steel frame 10.406

Frame pocket for timber frame 10.405

*LH/RH

Accessories for Studio-Rondo, Studio-Classic, Studio-Gala

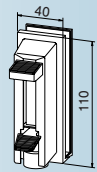

Push-on telescopic door hold-open,
8, 10 and 12 mm glass thicknesses **12.320**

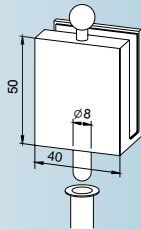

Slide over door bolt
with floor socket
8 mm glass thickness **12.301**
10 mm glass thickness **12.302**

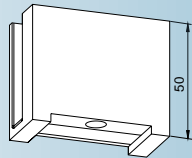

Slide over strike box **12.314**

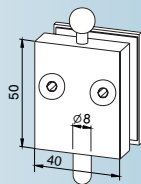

Door bolt on glass cut-out **12.312**
8 mm glass thickness

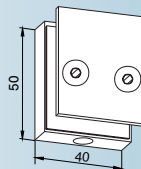

Strike box on glass cut-out **12.313**
8 mm glass thickness

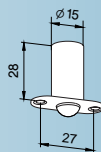
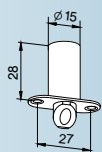

Door catch
Plastic **12.300**
with round bolt **12.305**

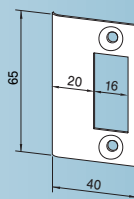
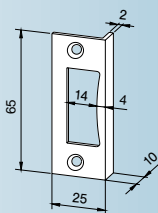

Corner strike plate **10.401**
for 24 mm rebate depth

Strike plate
for 40 mm rebate depth
Steel **10.085.001.40**
Brass **10.085.002.40**